

MDI 13/6 M4 0,12kW (300716300)

GENERAL DATA



MEDIUM PRESSURE FAN WITH FORWARD IMPELLER AND IN STAINLESS STEEL CONSTRUCTION

MANUFACTURING FEATURES:

- Welded stainless steel AISI 304 housing.
- Stainless steel simple inlet forward curved impeller.
- Standard asynchronous squirrel-cage motor with IP-55 protection and Class F insulation. Manufactured with standard voltages: 230V 50Hz for single phase motors, 230/400V 50Hz for three phase motors.
- Available positions (to be indicated in case of order): LG270, LG0, LG45, LG90, LG135, LG180, LG225, LG315, RD0, RD45, RD90, RD135, RD180, RD225, RD270, RD315.
- The indicated codes correspond to the model in position LG270.

APPLICATIONS:

Designed for inline installation, they are suitable for:

- Industrial applications, extraction or injection of air.
- Cooling of machines and parts.
- Clean air transport.
- Corrosive air transport.
- Maximum working temperature: carried air: 130°C, ambient: 1ph 50°C, 3ph 60°C.

UNDER REQUEST:

- 60Hz fans and special voltages.
- 2 speed motors (three phase motors).

PERFORMANCE CURVE

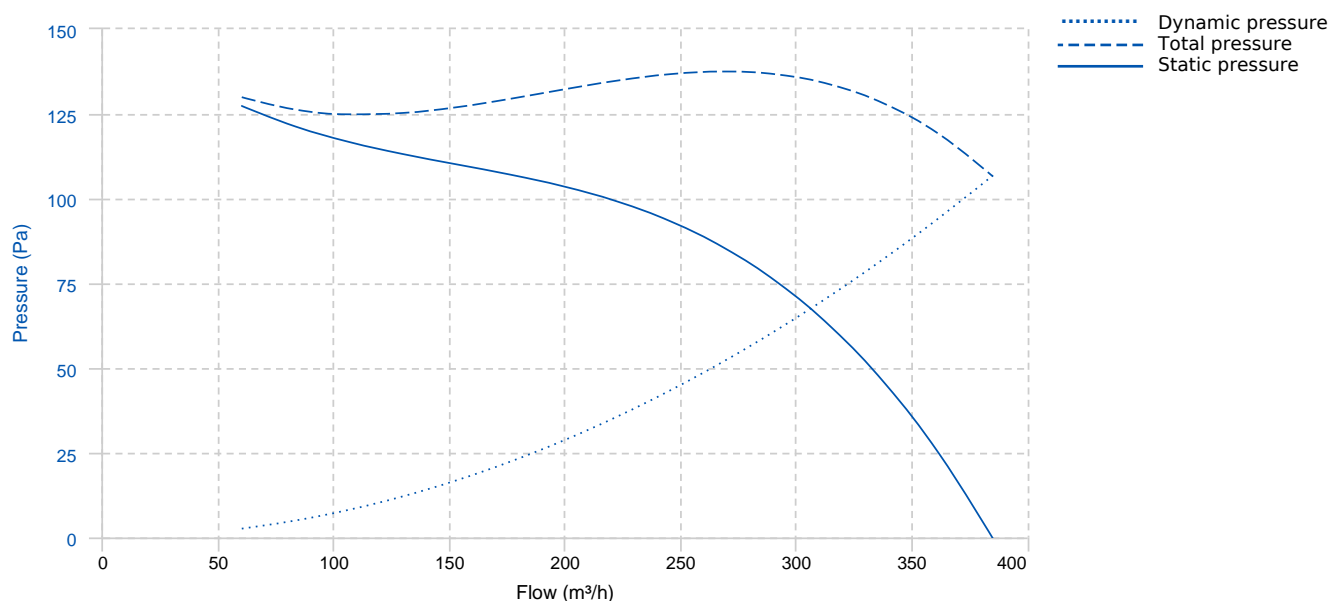

TECHNICAL DATA

Fan							
RPM	1380	Approx. weight	4.9 kg	Max. Flow	380 m³/h		
Motor							
Power	0,12 kW	RPM	1380	Capacitor	6µF 450V	I max. (230V)	0,93 A
Size	63	Approx. weight	4.5 kg	Efficiency (%)	59,1 %	FP	0,95

DIMENSIONS

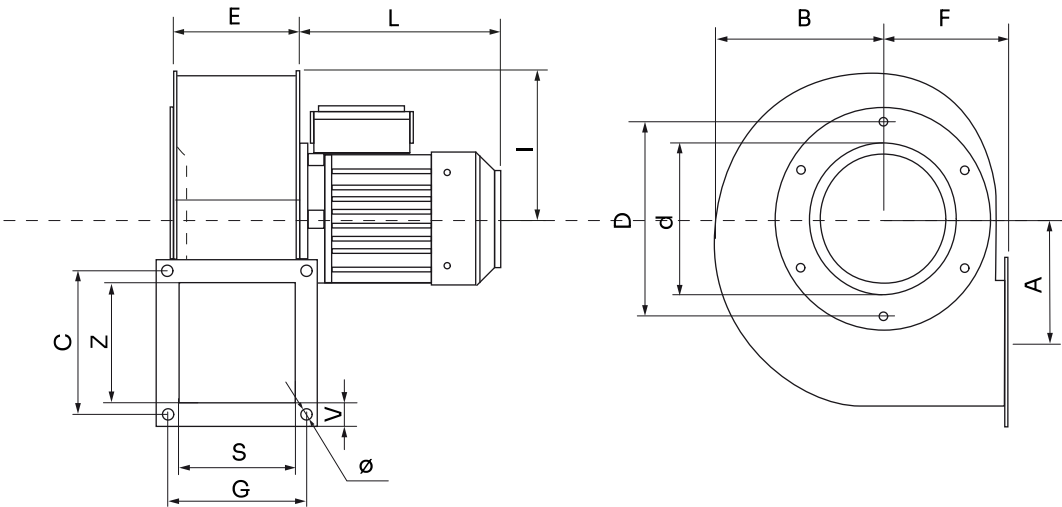

Dimensions (mm)									
A	92	B	125	C	110	D	158	E	92
F	104	G	110	I	110	L	190	S	90
V	20	Z	90	d	101	Ø	9x16		

WIRING DIAGRAM

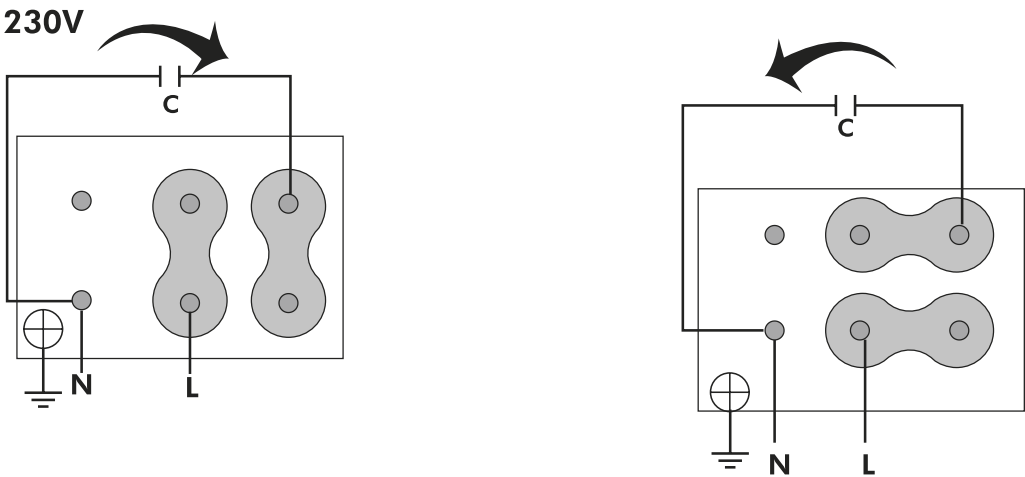

ACCESSORIES



SAFETY SWITCH
INT 25 3P A
REF: INT253PA



STAINLESS STEEL INLET PROTECTION GUARD
FOR CENTRIFUGAL FANS
RAI 13/8-13/6
REF: 300716502



ACOUSTIC CABINS FOR CENTRIFUGAL FANS
AB (GENERIC)

SPARE PARTS

	Code	Model	Qty
4	720301112	MOTOR 0,12kW M4 B5 230V	x1